

# MV AEGEAN ODYSSEY DECK PLAN

## SHIP'S SPECIFICATION

Ship's Tonnage	11,563
Length	461 feet
Beam	67 feet
Draft	20 feet
Cruising Speed	18 knots
Passenger Decks	7
Stabilisers	2
Passenger Staterooms/Cabins	198
Passengers – lower beds	378
Classification Society	Lloyd's Register London
Ship's Registration	Greece

## SHIP'S AMENITIES

- 2 Restaurants plus outdoor terrace dining
- 3 Lounges
- 4 Bars
- Lecture Theatre and Cinema
- Library
- Shop
- Photo Gallery
- Internet Centre
- Outdoor pool
- Spa and Jacuzzi
- Beauty Salon
- Medical Centre
- Telephone, Fax and E-mail via satellite
- Satellite TV, Hair Dryer and Personal Safe in every cabin

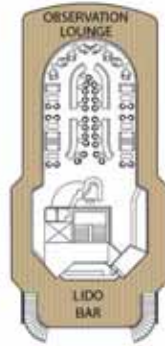

OBSERVATION DECK

### KEY

- Single cabins
- ▲ Third pullman berth in these cabins
- Third/fourth pullman berth in these cabins
- # Disabled Cabins



LIDO DECK

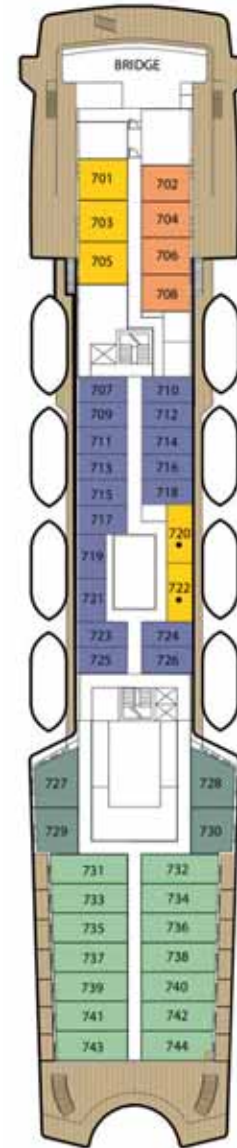

BRIDGE DECK

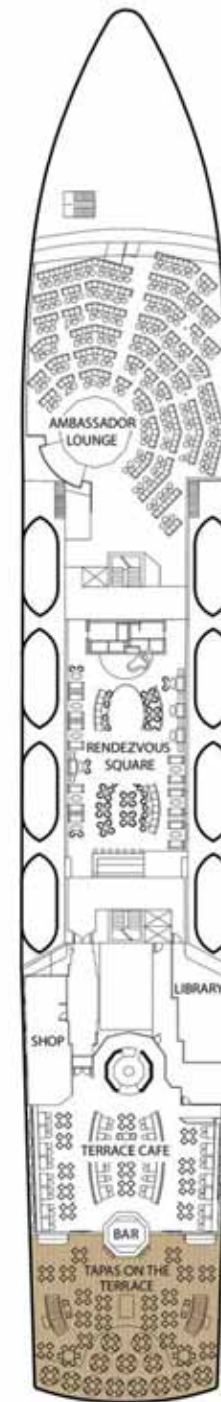

PROMENADE DECK

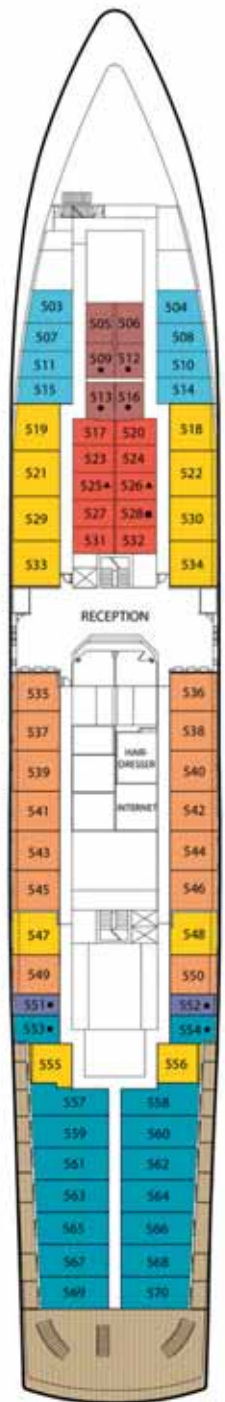

BELVEDERE DECK

# STATEROOMS & CABINS

All staterooms/cabins have bath and/or shower, flat screen TV, safe, hair dryer and are fully air-conditioned. Concierge Class staterooms (categories A to G) have additional amenities as detailed on page 19. The diagrams of the cabins shown here are indicative. Not all categories are shown. The sizes, layout and bed configuration will vary within a category. The areas shown are averages and include the balcony. Beds may be fixed double (queen size), fixed separate twin beds or twin beds that can be converted into double beds. All outside staterooms/cabins have windows except Category K which has portholes.

**CATEGORY A: Owner's Suites**  
550 sq ft staterooms located on Lido Deck. Marble bathrooms, dressing area, separate sitting area and private balcony. Convertible twin beds.

**CATEGORY B: Junior Balcony Suites**  
310 sq ft staterooms located on Lido Deck. Marble bathrooms, walk-in closet, sitting area and private balcony. Convertible twin beds.

**CATEGORY C/D: Deluxe Balcony Staterooms**  
275 sq ft staterooms located on Lido, Bridge and Belvedere Decks. Walk-in showers or bath, sitting area and private balcony. Fixed double bed, separate twins or convertible twins depending on cabin selected. Cabins 807, 808 on Lido Deck are smaller and do not have a sitting area.

**CATEGORY F: Deluxe Staterooms**  
215 sq ft staterooms located on Bridge and Belvedere Decks. Private bath/shower. Convertible twin beds. Cabins 555, 556 are smaller but have a balcony.

**CATEGORY G: Deluxe Staterooms**  
200 sq ft staterooms located on Bridge and Belvedere Decks. Walk-in shower. Convertible twin beds.

**CATEGORY H/I/J: Premium Outside Cabins**  
130 sq ft cabins located on Bridge, Belvedere and Columbus Decks. Fixed twin beds with private shower. *Category H cabins on Bridge deck have views partially obstructed by lifeboats. Category K Standard Outside Cabins are similar in size and layout but with portholes in place of windows.*

**CATEGORY L/M: Premium Inside Cabins**  
**CATEGORY N: Standard Inside Cabins**  
130 sq ft cabins located on Belvedere and Columbus Decks. Fixed twin beds with private shower.

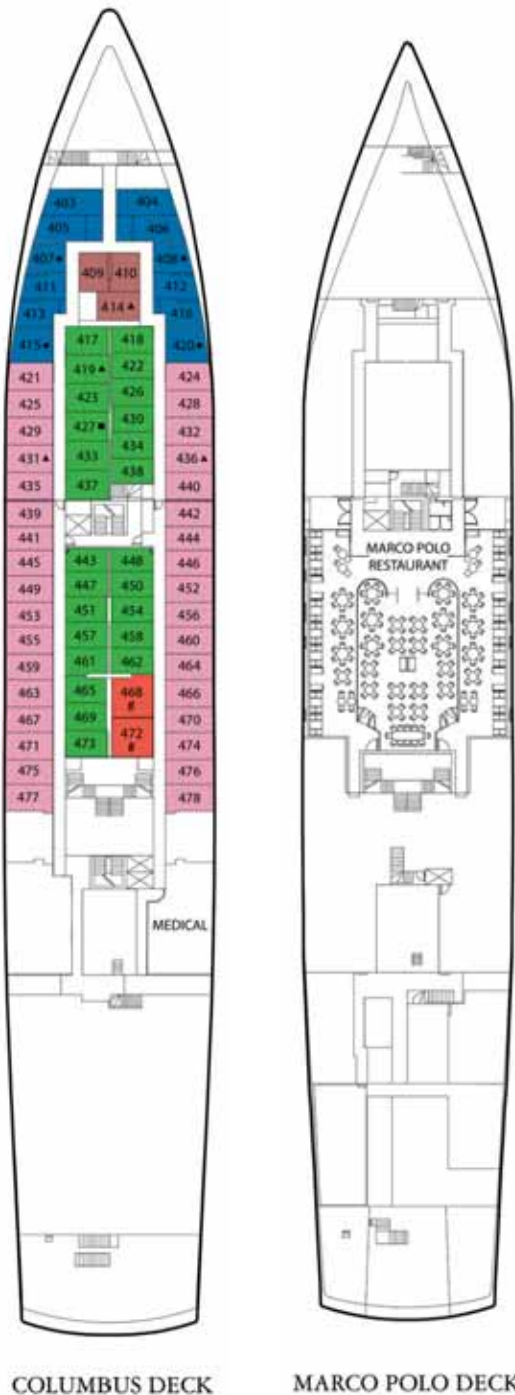

Category A - Owner's Suite, balcony



Category B - Junior Suite, balcony



Category C/D - Deluxe Stateroom, balcony

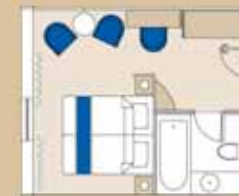

Category F - Deluxe Stateroom, outside



Category G - Deluxe Stateroom, outside



Category H/I/J - Premium, outside

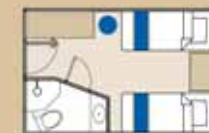

Category L/M/N - Premium & Standard, inside



Category N, Standard inside



Category H/I/J, Premium outside



Category C, Deluxe balcony stateroom

Please note: Staterooms and cabins illustrated here are computer impressions. Final decoration is subject to change.

#### YOUR CRUISE FARE INCLUDES

- Scheduled economy class air fare (see page 65)
- Cruise on mv Aegean Odyssey as detailed on the itinerary of your choice
- All meals on board the Aegean Odyssey
- Selected shore excursions as detailed in each itinerary
- Meals on full-day and overnight excursions (except on the full-day tours from Corinth and Sorrento, when lunch is under your own arrangements)
- All meals on the land tours in the Middle East
- All on-board gratuities for restaurant and cabin staff
- Selected wine with dinner (beer or soft drinks if preferred)
- Experienced team of guest speakers giving talks on subjects outlined on each itinerary
- Transfers between airports and mv Aegean Odyssey abroad
- Portage of luggage to/from your cabin

#### YOUR CRUISE FARE DOES NOT INCLUDE:

- Transport to and from your UK departure airport
- Supplementary shore excursions
- Drinks (other than those included at dinner) and other items of personal expenditure
- Salon treatments
- Laundry
- Internet and telephone calls
- Visas and airport taxes where these are payable locally
- Government fees, surcharges and local taxes