

Hurtigruten's top
agent in Scotland,
call our experts now!



Special Selection 2012 | 2013

Fly from your local airport. Featuring Greenland, Spitsbergen and Antarctica.
Booking with Connoisseur means booking with confidence.



HURTIGRUTEN

Book early for
the best
discounts!

NORWAY – *your way!*

Whether you are a Norway enthusiast or a first time traveller our expert staff will be able to help you choose your dream holiday to this wonderful country; the choice is yours:

- Daily departures – 364 days of the year
- We can extend your stay in any port of your choice
- Specialised cruises from photographic to astronomy to wildlife spotting
- Combine a sea voyage with rail, coach or land activity
- Mix and Match – experience more than a vessel of the 14 strong fleet from small traditional heritage ships to larger state-of-the-art modern vessels
- Add a city break in Oslo, Bergen, Trondheim or Tromsø



HURTIGRUTEN EXPERIENCES

So you have chosen your cruise and along the way there are numerous places to stop off and explore – but what about booking an excursion that offers you the opportunity to get that bit closer to the action, has been carefully planned out with you in mind and which offers you the opportunity not only to see more of the stunning scenery but to take part in activities within it and to meet people who live locally on these occasions and sample their culture and history at first hand.

Connoisseur's most often requested excursions include:

- Lofoten Islands – stunningly beautiful islands – quaint fishing villages, quiet bays, sandy beaches, sheltered fjords – a true inspiration for many of Norway's most talented artists
- Geirangerfjord – impossibly high mountains on either side of the Unesco listed fjord – panorama 1 and 2 offer a view of the fjord from a different perspective along with exciting an exciting journey along the Trollstigen Pass and its 11 hairpin bends!
- Husky-dog sledging or snowmobiling – experience 'the white stuff' close up on these Norwegian transport methods old and new – travelling across unspoilt landscapes
- Other popular highlights include Midnight concerts in the Arctic cathedral and city tours of Trondheim. Ask our experienced team today – we are happy to help.



Exhilarating Husky-dog sledging



Thrilling snowmobiling

ARCTIC WONDERS

Combining the Classic Voyage North with a night in the fantastic Snow Hotel, this voyage adds a new dimension to our choice of itineraries sailing beneath the elusive Northern Lights. Set sail from the UNESCO-listed Bergen in the south, enjoying 7 days traversing the calm coastal waters, passing Ålesund, Trondheim and Tromsø before reaching Kirkenes on the Russian border. Husky-dog sledging, snowmobiling and snow-shoeing are available as excursions en route!



The magical Northern Lights



Enjoy a unique experience in the Snow Hotel at Kirkenes

The West Coast of Spitsbergen – EXPLORER VOYAGE

Sail along the northwest coast of Spitsbergen, journey through a landscape of breathtaking fjords and gigantic glaciers, all set before a magical backdrop of jagged mountain peaks. This coastline is surprisingly rich in wildlife and historical remains, offering a fascinating insight into the heroic efforts of the polar explorers of past times.

VOYAGE ITINERARY

DAY 1 Longyearbyen and Barentsburg

Longyearbyen is a Norwegian settlement often referred to as the capital of Svalbard. This is a lively small town, situated in a fantastic Arctic landscape. The history and heritage of coal mining can be seen everywhere. Barentsburg is a Russian settlement with an exotic collection of Russian artefacts and architecture. This "Company town" was built in 1935 around the entrance to the coal mine.

DAY 2 Hornsund

The landscape of Hornsund is largely alpine with the majestic Hornsundtinden mountain soaring highest of all. Let your imagination run wild while spending the day in these extraordinary surroundings.

DAY 3 Bellsund

In Bellsund we will attempt to land on either Ahlstrands peninsula or in Calypsobyen. Later we may sail towards the beautiful Vårsolbukta, named after the motor cutter "Vaarsol" that was used by the Norwegian Svalbard Expedition in 1914.

DAY 4 Kongsfjord

Kings Bay is the largest fjord on the North West coast of Spitsbergen. The landscape varies from large tundra plains to alpine peaks with dramatic glaciers calving into the ocean. At 78° 55' N, Ny Ålesund is the world's northernmost permanently inhabited community, where a number of countries run their own national

research stations. Activity here is particularly high in the summer. We hope to reach Moffen, a high latitude islet at 80°N with a walrus colony and bird sanctuary. The atoll-like shape of the island made it a perfect safe harbour for any early whalers caught in bad weather.

DAY 5 Woodfjord and Liefdefjord

These large fjords in North Spitsbergen are striking in varied landscape. We will cruise towards the Monaco glacier, passing a number of small islets where eider ducks nest during the summer. If we are lucky we might spot a polar bear searching for eggs.

DAY 6 North West Spitsbergen National Park

Known locally as the North West Corner, this area has a long history of exploration. When Dutchman Willem Barents first found Svalbard in 1596, the name he gave to this new land was 'Spitzbergen' ("Spitz" meaning sharp) reflecting the sharp and steep mountains in the area. Magdalenefjorden is home to a very important piece of cultural heritage; a whaling station from the 16th century, including a graveyard of whalers that died during the first "oil adventure".

DAY 7 Icefjord

In central Spitsbergen, Icefjord is the largest fjord system in Svalbard. One of the most prominent mountains here is Alkhornet, where thousands of Brünnich guillemots nest during the summer season.

DAY 8 Longyearbyen

Sadly, every explorer voyage has to come to an end.

Hopefully you will be recalling the memory of that polar bear, the calving glacier front or the buzzing birdlife – or simply enjoying the subtle, odd feeling of having spent time on top of the globe, just a few hundred kilometres from the Geographical North Pole.



COME WITH US AND EXPLORE GLORIOUS GREENLAND

The Land of the People

Kalaallit Nunaat is the Greenlandic name of the world's biggest island. Meaning "land of the people" the name describes Greenland perfectly.

MS Fram brings you not only close to the fantastic mountain formations, endemic wildlife and icebergs, but also to the welcoming people of Greenland. Like no other polar destination, Greenland offers close interaction and unique cultural experiences together with breathtaking nature. The Inuit people's heritage and fascinating way of life is best told by themselves and we will take you to the storytellers.

Hurtigruten work closely with the Greenlandic people who are very welcoming to guests and open their homes to visitors for a traditional "kaffemik. This offers a fascinating insight into their lives.

80% of Greenland's 2.1 million km² is covered by ice and we recommend you always have your camera handy as icebergs of every imaginable shape and size may appear at any time, leaving memories that will last a lifetime.



Uummannaq – situated at the foot of a 1,170 metres tall mountain

North East Greenland – NATIONAL PARK EXPEDITION

Join an extraordinary and exclusive expedition taking you to three Arctic islands; Spitsbergen, Greenland and Iceland. The emphasis is on the rarely visited North East Greenland National Park which is the largest in the world and the least visited with only about 500 visitors every year. This is a special opportunity to experience the Arctic in autumn before winter closes in and makes this corner of the planet uninhabitable for all but the hardest of species.

VOYAGE ITINERARY

DAY 1 Longyearbyen and Barentsburg
Longyearbyen is a Norwegian settlement often referred to as the capital of Svalbard. This is a lively small town, situated in a fantastic Arctic landscape. Barentsburg is a Russian settlement with an exotic collection of Russian artefacts and architecture.

DAY 2 Kongsofjorden and North West Spitsbergen National Park
Kings Bay is the largest fjord on the North West coast of Spitsbergen. The landscape varies from large tundra plains to alpine peaks with dramatic glaciers calving into the ocean. At 78° 55' N, Ny Alesund is the world's northernmost permanently inhabited community, where a number of countries run their own national research stations. Activity here is particularly high in the summer. When Dutchman Willem Barents first discovered Svalbard in 1596, the name he gave to this new land was 'Spitzbergen' ("Spitz" meaning sharp), reflecting the sharp and steep mountains in the area. Magdalenefjorden is home to a very important piece of cultural heritage; a whaling station from the 16th century, including a graveyard of whalers who died during the first "oil adventure".

DAY 3 Mofen/At Sea
Moffen is a high latitude islet at 80°N with a walrus colony and bird sanctuary. The atoll-like shape of the island made it a perfect safe harbour for any early whalers caught in bad weather.

DAY 4 - 10 North East Greenland National Park, Greenland
We're leaving the warmer waters of the Gulf Stream to enter the cold water current that follows the coast of East Greenland. We will make our way south, within the boundaries of North East Greenland National Park; the largest national park on Earth. The mountains are alpine, the waters are scattered with large icebergs and the valleys are populated with Musk oxen. This voyage will take you to one of the most isolated places on Earth – but aboard one of the most capable specially-built expedition vessels. Our expert guides and lecturers will safely guide you on hikes and small boat trips in addition to briefings and lectures on the places we visit.

DAY 11 Ittoqqortoormiit (Scoresbysund)
Ittoqqortoormiit or Scoresbysund is the most isolated town in Greenland. The trappers living here are the only ones allowed to hunt within the North East Greenland National Park.

DAY 12 Ísafjörður
Sailing across the Denmark Strait to Iceland we arrive at Ísafjörður on the Snæfellsnes peninsula. Snæfellsnes is known as "Iceland in a nutshell" due to the diversity of its landscape; lava and rock formations, glaciers and volcanic activity, and a wealth of bird life.

DAY 13 Grundarfjörður, Iceland
Grundarfjörður is considered a place of unusual beauty and is one of very few places in the world where the authorities have provided reserved areas for the "hidden people" or elves!

DAY 14 Reykjavik, Iceland
Reykjavik is the world's northernmost capital city and referred to locally as the "smallest big city on Earth". In relative close surroundings of the city you may find glaciers, waterfalls, geysers and mountains. Here is where your voyage ends.

Disko Bay – THE HEART OF GREENLAND

This expedition along Greenland's west coast is a fascinating meeting with the Inuit culture and the stunning land they inhabit. Only accessible by boat, the small settlements give you a genuine picture of Greenlandic life. The spectacular scenery and Midnight Sun provide a stunning backdrop for the voyage.

VOYAGE ITINERARY

DAY 1 Copenhagen/Kangerlussuaq
Begin your Greenland experience in Copenhagen with our specially chartered flight to Kangerlussuaq, the main gateway to Greenland. Situated close to the majestic inland ice that covers more than 80% of Greenland, this desert-like place is home to only 600 people.

DAY 2 Sisimiut
Sisimiut is the second largest community in Greenland. Here you'll find fishing trawlers, a shipyard and a busy fish processing factory. We recommend a visit to the arts and crafts workshop close to the pier. Here you may watch the local craftsmen create traditional jewellery and purchase local souvenirs.

DAY 3 Qeqertarsuaq
Qeqertarsuaq is situated on the old volcanic island of Disko and plays host to the Arctic Station, part of Copenhagen University, studying flora, fauna and the climate. Enjoy a stroll along the beach with its grounded icebergs or join the highly recommended walking tour to Blåsedalen, an area rich in high Arctic flora.

DAY 4 Uummannaq/Ukkusissat
The town of Uummannaq is situated in scenic surroundings at the foot of a 1170m heart-shaped mountain. Here, you may join a walking tour, or just

stroll around this beautiful town on your own. In the evening we will be calling Ukkusissat, a traditional hunting and fishing settlement of about 190 welcoming inhabitants.

DAY 5 Eqip Sermia
The five kilometre glacier front of Eqip Sermia is constantly calving icebergs. Here you will have an outstanding possibility to experience the glacier and sense the grandeur of nature.

DAY 6 Ilulissat
Ilulissat means iceberg in Greenlandic, and this town lives up to its name. The most productive glacier in the Northern Hemisphere, Sermeq Kujalleq feeds enormous bergs into the Ilulissat Icefjord. As a result this area is on UNESCO's list of World Heritage sites.

DAY 7 Itilleq
This small isolated settlement close to the Arctic Circle is home to about 130 inhabitants who make their living by traditional fishing and hunting. Itilleq always welcomes us for an active stay in their settlement to give us a closer understanding of their culture.

DAY 8 Kangerlussuaq
In the early 1960's 27 Musk oxen were introduced to Kangerlussuaq from north east Greenland and today their numbers are over 10,000. We will have time for a closer look at the area before our evening flight to Copenhagen.

DAY 9 Kangerlussuaq/Copenhagen
Arrival in Copenhagen next day.



BOOK EARLY FOR THE BEST DISCOUNTS SAVE UP TO 20% ON SELECTED VOYAGES & DATES

CLASSIC ROUND VOYAGE

12-day voyage • Bergen – Kirkenes – Bergen

Hurtigruten's 12-day Classic Round Voyage is unique to the world of cruising and the best way to explore Norway's incredible coastline with its breathtaking fjords, friendly communities and beautiful wildlife. Starting in Bergen, the Gateway to the Fjords, this 12 day voyage takes in over 34 ports of call.

MS MIDNATSOL

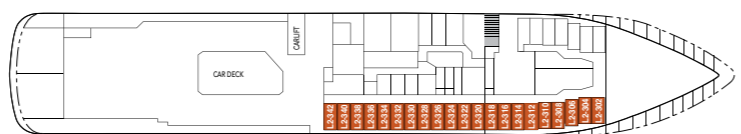
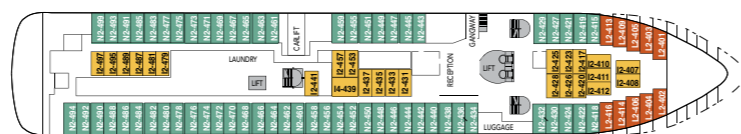
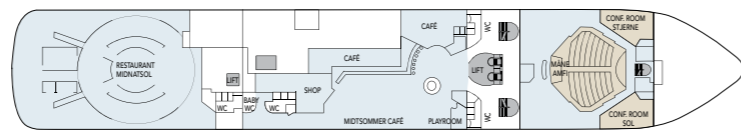
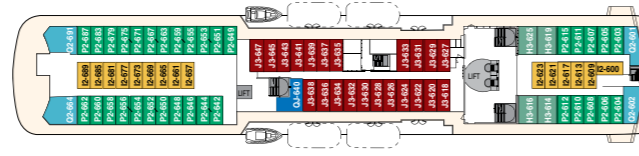
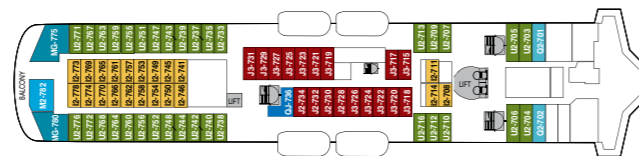
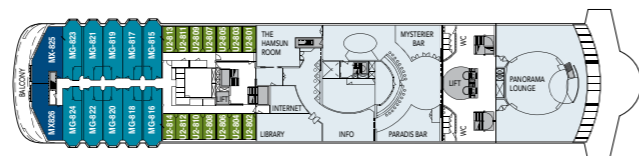
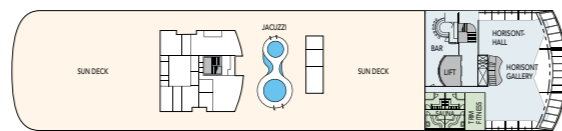

CLASSIC NORWEGIAN DISCOVERY

11-day voyage • Bergen – Kirkenes – Trondheim

Days 1–11 of the Classic Round Voyage

The Classic Norwegian Discovery combines many highlights of the Classic Round Voyage with the freedom to add an extension to your voyage in Trondheim and Oslo plus the impressive scenic rail journey between these two fascinating Norwegian cities.

CLASSIC VOYAGE NORTH

7-day voyage • Bergen – Kirkenes

Days 1–7 of the Classic Round Voyage

Your first night on this itinerary is spent in Bergen.

Next morning, join the Voyage North and begin your seven day cruise to Kirkenes calling at a total of 34 ports and enjoying a range of interesting sights along the way. The many highlights include Trondheim with its Gothic Cathedral, a crossing of the Arctic Circle, Tromsø, the Arctic Capital, and the opportunity to experience mainland Europe's most northerly point – North Cape. Finally, the journey ends at Kirkenes, just a few kilometres from the Russian border. A night in Oslo is included with your return flight to the UK.

CLASSIC VOYAGE SOUTH

6-day voyage • Kirkenes – Bergen

Days 7–12 of the Classic Round Voyage

Enjoy a night in Oslo before joining a flight to Kirkenes where embarkation takes place. There are 34 ports of call along the course of your southbound journey to Bergen, the gateway to the fjords. Highlights of this voyage include a daytime sailing through the beautiful Lofoten Islands, a crossing of the Arctic Circle and regular shore excursions including the world's most northerly town, Hammerfest, and the Viking capital, Trondheim. An overnight stay in Bergen allows you time to explore this beautiful Hanseatic city before boarding a flight back home.



If you have travelled with Hurtigruten you will become a member of their Ambassador's programme, which offers special privileges to repeat guests. Please advise us at the time of booking so please advise us if you are a member at the time of booking so apply any savings as we can offer members up to 10% off Classic Voyages and a 5% discount on the Explorer programme. In addition members will enjoy a range of complimentary on board benefits as well as discounts on selected shore excursions, booked on board.

NORWAY

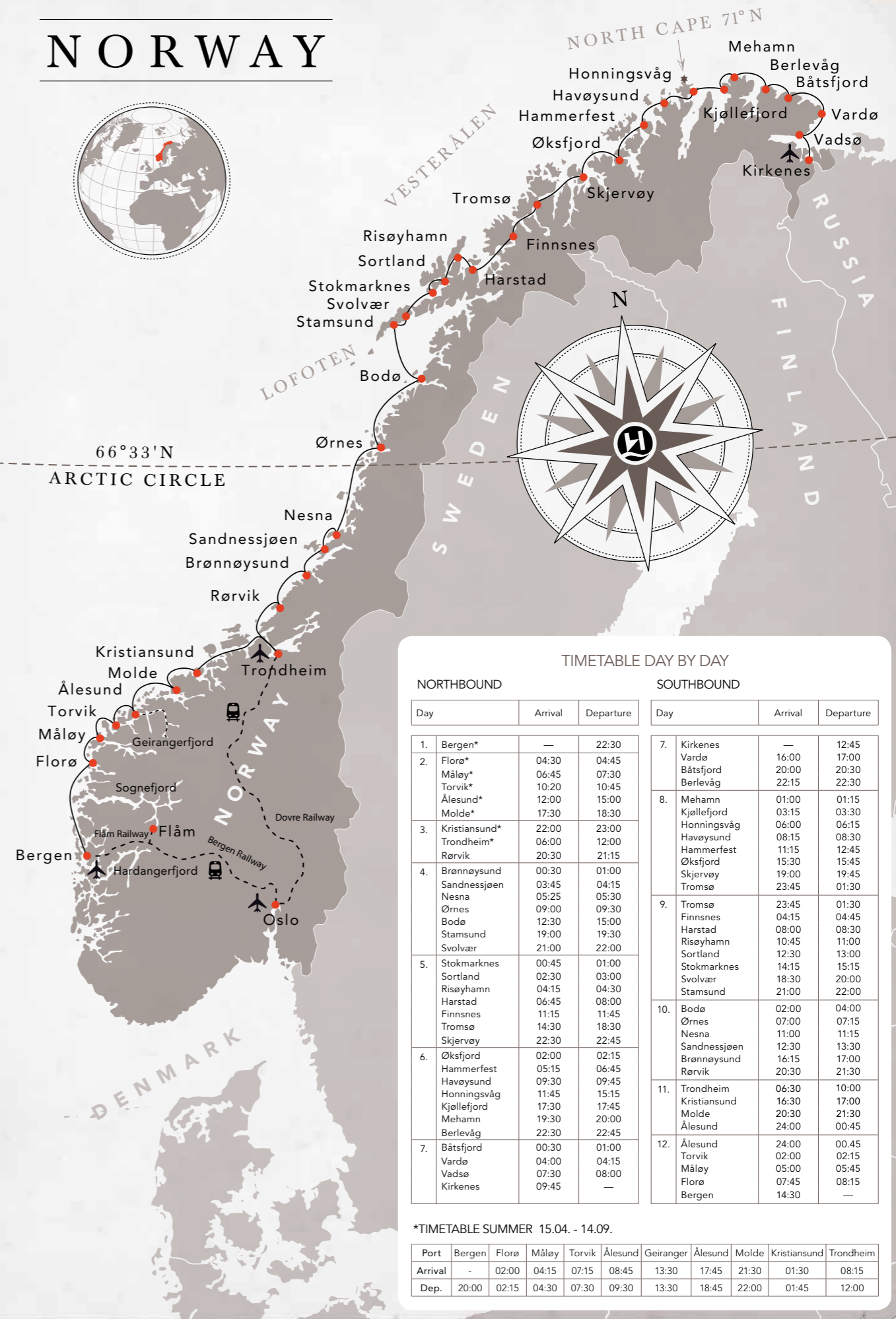

TIMETABLE DAY BY DAY

| NORTHBOUND | | | SOUTHBOUND | | |
|------------------|---------|-----------|---------------|---------|-----------|
| Day | Arrival | Departure | Day | Arrival | Departure |
| 1. Bergen* | — | 22:30 | 7. Kirkenes | — | 12:45 |
| 2. Flørø* | 04:30 | 04:45 | Vardø | 16:00 | 17:00 |
| Måløy* | 06:45 | 07:30 | Båtsfjord | 20:00 | 20:30 |
| Torvik* | 10:20 | 10:45 | Berlevåg | 22:15 | 22:30 |
| Ålesund* | 12:00 | 15:00 | 8. Mehamn | 01:00 | 01:15 |
| Molde* | 17:30 | 18:30 | Kjøllefjord | 03:15 | 03:30 |
| 3. Kristiansund* | 22:00 | 23:00 | Honningsvåg | 06:00 | 06:15 |
| Trondheim* | 06:00 | 12:00 | Havøysund | 08:15 | 08:30 |
| Rørvik | 20:30 | 21:15 | Hammerfest | 11:15 | 12:45 |
| 4. Brønnøysund | 00:30 | 01:00 | Øksfjord | 15:30 | 15:45 |
| Sandnessjøen | 03:45 | 04:15 | Skjervøy | 19:00 | 19:45 |
| Nesna | 05:25 | 05:30 | Tromsø | 23:45 | 01:30 |
| Ørnes | 09:00 | 09:30 | 9. Tromsø | 23:45 | 01:30 |
| Bodø | 12:30 | 15:00 | Finnsnes | 04:15 | 04:45 |
| Stamsund | 19:00 | 19:30 | Harstad | 08:00 | 08:30 |
| Svølvær | 21:00 | 22:00 | Risøyhamn | 10:45 | 11:00 |
| 5. Stokmarknes | 00:45 | 01:00 | Sortland | 12:30 | 13:00 |
| Sortland | 02:30 | 03:00 | Stokmarknes | 14:15 | 15:15 |
| Risøyhamn | 04:15 | 04:30 | Svølvær | 18:30 | 20:00 |
| Harstad | 06:45 | 08:00 | Stamsund | 21:00 | 22:00 |
| Finnsnes | 11:15 | 11:45 | 10. Bodø | 02:00 | 04:00 |
| Tromsø | 14:30 | 18:30 | Ørnes | 07:00 | 07:15 |
| Skjervøy | 22:30 | 22:45 | Nesna | 11:00 | 11:15 |
| 6. Øksfjord | 02:00 | 02:15 | Sandnessjøen | 12:30 | 13:30 |
| Hammerfest | 05:15 | 06:45 | Brønnøysund | 16:15 | 17:00 |
| Havøysund | 09:30 | 09:45 | Rørvik | 20:30 | 21:30 |
| Honningsvåg | 11:45 | 15:15 | 11. Trondheim | 06:30 | 10:00 |
| Kjøllefjord | 17:30 | 17:45 | Kristiansund | 16:30 | 17:00 |
| Mehamn | 19:30 | 20:00 | Molde | 20:30 | 21:30 |
| Berlevåg | 22:30 | 22:45 | Ålesund | 24:00 | 00:45 |
| 7. Båtsfjord | 00:30 | 01:00 | 12. Ålesund | 24:00 | 00:45 |
| Vardø | 04:00 | 04:15 | Torvik | 02:00 | 02:15 |
| Vadsø | 07:30 | 08:00 | Måløy | 05:00 | 05:45 |
| Kirkenes | 09:45 | — | Flørø | 07:45 | 08:15 |
| | | | Bergen | 14:30 | — |

*TIMETABLE SUMMER 15.04. - 14.09.

| Port | Bergen | Flørø | Måløy | Torvik | Ålesund | Geiranger | Ålesund | Molde | Kristiansund | Trondheim |
|---------|--------|-------|-------|--------|---------|-----------|---------|-------|--------------|-----------|
| Arrival | - | 02:00 | 04:15 | 07:15 | 08:45 | 13:30 | 17:45 | 21:30 | 01:30 | 08:15 |
| Dep. | 20:00 | 02:15 | 04:30 | 07:30 | 09:30 | 13:30 | 18:45 | 22:00 | 01:45 | 12:00 |

JOIN US IN HUNTING THE AURORA BOREALIS!

WINTER AND THE NORTHERN LIGHTS

In the winter, the sun is low on the horizon and, north of the Arctic Circle, can even be below the horizon for some weeks. This natural phenomenon creates a fascinating light. You can never know when the Aurora Borealis, the Northern Lights, will appear, but sailing with Hurtigruten will provide the best possibilities to experience the magic colour show from light green to dark purple flickering across the Arctic sky.

EXPLORE THE ARCTIC SCENERY

Unlock the wonders of the Arctic north with special shore excursions. Spend an unforgettable night in a snow hotel. Embark on a snowmobile safari in Lapland. Thrill to the action of dog sledging on the island of Kvaløya. Whatever the activity, you are in the middle of spectacular winter scenery.

HUNTING THE LIGHT

The term "Hunting the Light" originates from one of our captains. He had observed guests out on deck chasing the most magical of all natural phenomena; the Northern Lights. "Hunting the Light" is a signature of Hurtigruten's winter voyages, hunting and experiencing the many and beautiful types of light visible during the winter months.



38 Silverknowes Road, Edinburgh EH4 5LF

Tel: **0845 1300 788**

Email: enquiries@connoisseurcruising.com

Visit: www.connoisseurcruising.com



HURTIGRUTEN